

 **FUTUR-K6AM**

  
Professional adjustable stock

[www.futur-k.com](http://www.futur-k.com)

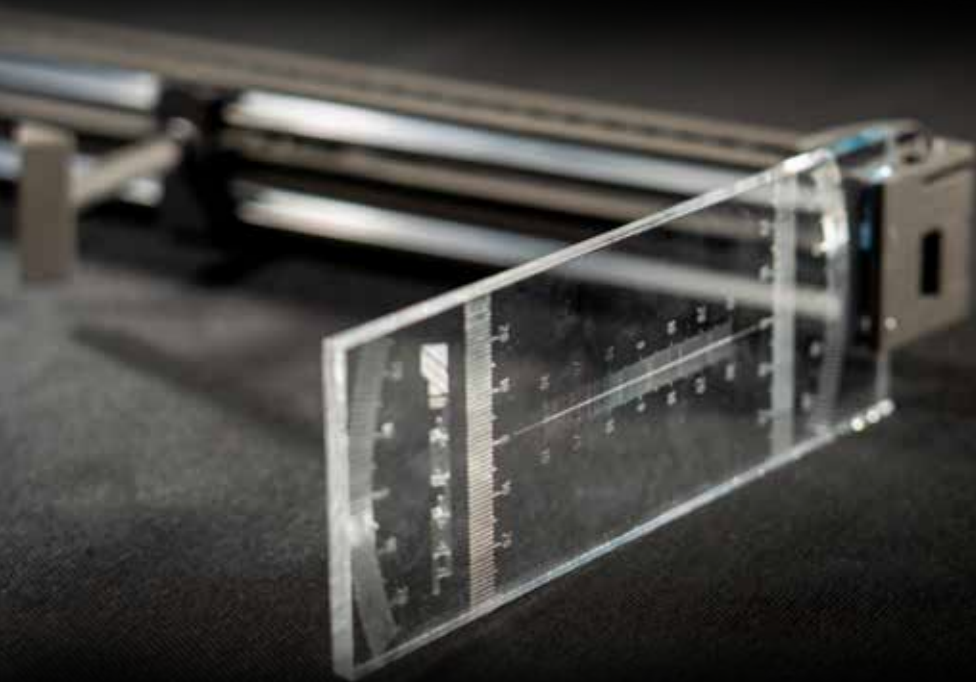

Installation, Use and Maintenance Handbook

**ADJUSTING CALIPERS Mod. "RSR01"**



ADJUSTING  
CALIPERS  
**Mod. "RSR 01"**

---

# Table of contents

<b>1.</b>	2001/95/EC Certificate of Product Conformity	4
<b>2.</b>	Purpose of the Handbook	5
	Importance of the Handbook	
	Purpose of the Handbook	
	Recipients	
	Preservation	
	Updates, Supplements, and Replacement General Information	
	Consultation	
<b>3.</b>	Product Description and Composition	8
	3.1. Tests carried out prior to Delivery	
	3.2. Scope of Application and Technical Features	
	Purpose, Aim and Components	
	Technical Data	
	Regular Use, Misuse, Incorrect Use, or Prohibited Use	
	Reasonably Foreseeable Misuse	
<b>4.</b>	Safety instructions	12
	4.1. Indications of Present Residual Risks	
	Residual Risks	
<b>5.</b>	Packaging Composition, Shipping and Commissioning	13
	5.1. Packaging Composition	
	Composition of the Product within its Packaging.	
	5.2. Storage, Shipping and Handling	
	Storage	
	Shipping, Lifting and Handling	
	5.3. Installation and Commissioning	
	Installation	
<b>6.</b>	Product use	18
	6.1. Intended Use	
	6.2. Precautions for Use	
<b>7.</b>	Maintenance, Lubrication, Cleaning	21
	7.1. General Information - Requirements of the Maintainer	
	7.2. Maintenance Interventions Interventions that can be performed by Product Users	
<b>8.</b>	Average Lifespan, Demolition and Disposal	22
	8.1. Average Lifespan 8.2. Demolition and Disposal	

# 1. 1. 2001/95/EC Certificate of Product Conformity

**CERTIFICATE OF PRODUCT CONFORMITY**  
**'2001/95/EC'**

I, the undersigned, representing the following manufacturer

<u>Manufacturer</u>	<b>FUTURMEC Srl</b> VAT number/Tax Code 02202510414
<u>Address</u>	Via Don Corrado Catani, n. 47 - 61049 Urbania

has appointed the following natural person, authorized to produce the technical documentation drawn up to ensure the conformity assessment process, in accordance with the Community Directive 2001/95/EC

Name	Sideri Michele
Address	Via Don Corrado Catani, n. 47 - 61049 Urbania

The **MANUFACTURER** hereby declares that the product:

Generic/Trade name	<b>RSR01</b>
Function	<b>Adjusting Calipers</b>
Manufacture year 1st version	<b>2023</b>

complies with all relevant provisions of the following Community Directive  
(including all applicable amendments)

2001/95/EC = Directive on general product safety
--

The technical documentation was drawn up in accordance with Article 3 and Article 5.

The manufacturer 'Futurmec Srl' on the basis of the information in its possession, if it finds that the product placed on the market presents risks to the consumer that are incompatible with the general obligation of safety, it undertakes from the outset to immediately inform the competent authorities of the Member States under the conditions set out in Annex I, specifying in particular the actions taken to prevent risks to consumers.

Urbania (PU), 06/06/2023

Stamp and Signature

.....

## 2. Purpose of the Handbook

### IMPORTANCE OF THE HANDBOOK

This Handbook is to be considered an **integral part of the Product:**

- a. must be kept throughout the lifespan of the Product.
- b. must accompany the Product in case of its divestiture.
- c. in addition to containing all useful information for the consumer, it contains all specifications for professionals regarding installation, adjustments and necessary maintenance.

### PURPOSE OF THE HANDBOOK

**The purpose of** the Handbook is to provide the consumer with all the necessary information so that, in addition to proper use of the supplied product, they are able to handle it as independently and safely as possible.

In addition, this manual has been compiled for the purpose of providing instructions and warnings to learn about the provided product, to understand its operating principles and limitations.



Before performing any operation on the product, the user should carefully read this handbook.

This handbook is an essential and integral part of the product. It contains important information, knowledge that is vital in order to perform properly under the safest conditions.

The product should be intended only for the use for which it is expressly designated. Any use of the product in any manner other than as indicated in this document shall be considered improper and therefore the manufacturer shall not be liable for it.

The manufacturer cannot be held responsible for any fault caused by unreasonable, improper and/or wrong use. Therefore, for any doubts, please contact the technical department of the manufacturer FUTURMEC Srl.

The consumer must read and understand the information in this handbook very carefully, as proper preparation, installation, use and maintenance of the product form the basis of the manufacturer-consumer relationship. If any doubt arises as to the correct interpretation of the instructions, contact the manufacturer of the product for clarification.

## RECIPIENTS

This Handbook, delivered in number of one copy along with the product, is provided as an integral part of the product, is intended for both consumers for their own use, and for qualified technicians (specifically: stock makers) licensed and competent to install and maintain the product. **Consumers engaged in the use of the product, should not perform operations reserved for Maintenance personnel or qualified technicians.** The product manufacturer shall not be liable for damages resulting from failure to comply with this prohibition.

## PRESERVATION



- > This Handbook must be stored in the immediate vicinity of the product, and/or in any case inside the appropriate “box - case” and, above all, away from liquids, moisture, excessive heat and anything else that may affect its readability.
- > Consult the handbook so as not to damage all or part of the contents.
- > Do not remove pages from the handbook.

## UPDATES, SUPPLEMENTS, AND REPLACEMENT



- > In case this handbook is damaged or lost, you can request a copy from the manufacturer Futurmec Srl.
- > This handbook reflects the state of the art at the time of manufacturing of the product; the manufacturer reserves the right to update production and consequently other editions of the handbook, with no obligation to update previous productions or handbooks except in special cases concerning the health and safety of individuals.
- > In any case, the consumer may request, by contacting Futurmec Srl, any updates or additions to the handbook, which may be necessary and will then be considered an integral part of the same.
- > In case the consumer would like to receive further information, please contact the manufacturer Futurmec Srl directly

## GENERAL INFORMATION



- > Use the product properly.
- > Comply with and apply the safety requirements outlined in the handbook.
- > Pay special attention to the specific chapter where any residual risks present on the product and the provisions to be followed by operators are highlighted.

- > Futurmec Srl is responsible for the product in its original configuration. Any intervention that alters the structure of the product must be approved and registered in the technical offices of Futurmec Srl.
- > Futurmec Srl is not responsible for damage caused by improper or incorrect use of the product and documentation.
- > Futurmec Srl is not liable for damages caused by the violation of mandatory rules, negligence, inexperience, carelessness and non-compliance with regulatory standards by the consumer and/or qualified technician in the field.
- > Futurmec Srl is not responsible for the consequences caused by the use of non-original spare parts.
- > Futurmec Srl reserves the right to make changes to this handbook and the product without the obligation of prior notice.
- > Futurmec Srl makes itself available to provide its expertise and cooperation in solving any problems that may arise.
- > Futurmec Srl is only responsible for the information given in the original Italian language version of the handbook.
- > Failure to comply with the provisions of this handbook will result in immediate forfeiture of the warranty.

### WARNING

For the sake of clarity some illustrations in this handbook may represent the product or parts of it with screws removed or not present!!!

**DO NOT use the product under such conditions.  
The product can work only if provided with all its parts**

### CONSULTATION



When consulting this Installation, Use and Maintenance Handbook, you will find the symbol shown at the side. It is associated with the words: DANGER, WARNING. This means that **you are in a dangerous situation**, which, if not observed, could cause damage or injury to the user.

The supplied product **poses no danger to the user when** used according to the instructions provided in this handbook, as long as the devices are kept in constant efficiency. Before any intervention on the product, pay close attention to any labels placed on it and/or its box packaging.

## MEANING OF SYMBOLS



### **DANGER**

Indicates the presence of a hazard to those working on the product and to those in the vicinity, so the reported activity must be carried out in accordance with current accident prevention regulations and the instructions in this handbook.



### **PRECAUTION**

Indicates a warning about useful information and/or further recommendations and/or cautions pertaining to the ongoing operation.



### **WARNING**

Indicates an operation that must be performed carefully to avoid causing damage to the product or property and people.



### **USER / CONSUMER**

Qualified and authorized person in charge of having the product adjusted and operated.



### **INSTALLER-MAINTENANCE COMPETENT PERSON (STOCK MAKER)**

Qualified and licensed technician capable of installing and performing routine and/or extraordinary installation and maintenance of the product at issue on any firearm.

## 3. Product Description and Composition

### 3.1. TESTS CARRIED OUT PRIOR TO DELIVERY

Prior to delivery, all installed components and the product itself in its supplied state divided into No. 2 components (Gauge Body and Supporting Bar), were subjected to meticulous visual and instrumental inspection to ensure compliance with regulatory requirements and contractual demands. Careful adherence to our instructions will ensure your product, under normal conditions of operation and use, great longevity and reliability of operation.

### 3.2. SCOPE OF APPLICATION AND TECHNICAL FEATURES

The product 'Adjusting Calipers Mod. RSR01' is a measuring tool, designed to assist the user in the optimal adjustment of all moving parts, such as comb height, pitch, translations and rotations, of the 'Adjustable Stock Mod. FUTUR-K6AM' installed on the stock of a firearm (rifle). Using the RSR01, it is possible to chart the optimal adjustment settings, in terms of comfort and shooting setting, thus creating the checklist of personal parameters, so as to achieve a perfect feeling with the firearm (rifle).





NUMERO PARTE	DESCRIZIONE
F0068-1	CORPO CENTRALE
F0068-2	INNESTO ASTA CARBONIO-CORPO CENTRALE
F0068-3	CARRELLO
F0068-4	TESTINA TASTATORE
F0068-5	GONIOMETRO
F0068-6	LISTELLO GRADUATO ORIZZ
F0068-7	POLICARBONATO RETROCALCIDO
F0068-8	LISTELLO GRADUATO VERTICALE
F0068-9	CORPO TASTATORE
F0068-10	MAGNETE
F0068-11	FASSELLO
F0068-13	SNODO RETROCALCIDO
F0068-14	PROFILO A U IN ALLUMINIO
F0068-15	TUBO IN ALLUMINIO
F0068-16	ASTA IN CARBONIO
F0068-17	SPINA
F0068-19	VITE A CANNOCCHIALE
F0068-12	TAPPINO
F0068-20	VITE A CANNOCCHIALE

The product should not be used for purposes and/or measurements other than those for which it was designed.

The installation of the adjusting calipers should only be performed by competent individuals (qualified field technicians).

The product consists of multiple parts, mainly made of nylon, carbon fiber and aluminum with anodized finishing, supplied by the manufacturer in No. 2 separate sections within the appropriate packaging.

The following is a parts list and an overall drawing with associated shot peening, in order to describe and identify the various constituent parts of the product, as well as to illustrate subsequently the method of its mounting and installation.

## TECHNICAL DATA

- |                   |                                  |
|-------------------|----------------------------------|
| 1. Length: 850 mm | 2. Depth: 300 mm                 |
| 3. Height: 60 mm  | 4. Net weight of product: 0,3 Kg |

## REGULAR USE, MISUSE, INCORRECT USE, OR PROHIBITED USE

The product described in this handbook is intended to be installed on the stock of the firearm (rifle) and used **by No. 1 person.**



- > In its **REGULAR**, and reasonably foreseeable, **USE**, the product may be used only:
1. As a measuring tool designed to assist the user in the optimal adjustment of all moving parts, such as comb height, pitch, translations and rotations, of the "Adjustable Stock Mod. FUTUR-K6AM" installed on the stock of a firearm (rifle).



- > The product should not be used **IMPROPERLY**; in particular:
1. It may not be used for other purposes and/or measurements other than those for which it was designed.
  2. It cannot be operated with parameters other than those given in the technical features table and with products and/or materials having features different from those given and previously indicated.
  3. Any use of the product in ways other than those indicated in this handbook, is to be considered improper and therefore the manufacturer declines all responsibility.
  4. The user shall be liable for damages resulting from failure to comply.



- > The product must not be used **IN AN INCORRECT OR PROHIBITED WAY**; in particular:
1. It must not be operated with components disassembled and/or not properly secured or removed;

2. it must not be operated without all measures having been taken by the installer about the elimination of residual risks indicated in this operating instructions handbook;
3. it must not be used in operations other than those explicitly indicated in this operating instructions handbook;
4. it must not be used in environments for which it is not intended to be operated, without appropriate safety measures having been taken in advance (see Section No. 3.2),
5. it is prohibited to allow untrained personnel to use the product.
6. USE BY CHILDREN AND YOUNG PEOPLE UNDER THE AGE OF 18 IS EXPRESSLY PROHIBITED.



**The manufacturer cannot be held responsible for any fault caused by unreasonable, improper, and/or wrong use.**

**However, the consumer/user is responsible** for damages resulting from failure to comply with the specified conditions of use.



In case of doubt, please contact the technical department of Futurmec Srl.



**USE BY CHILDREN AND YOUNG PEOPLE UNDER THE AGE OF 14 IS EXPRESSLY PROHIBITED**



**REASONABLY FORESEEABLE MISUSE**

It can be reasonably expected that the consumer will perform the following misuse maneuvers that should be avoided at all costs:

- a) Use the product to perform uses other than those specified in this document.
- b) Carry out the installation of the adjusting calipers in one's own-account without knowledge of the subject matter, and without being qualified to do so, thus compromising the safety and reliability of the product itself.
- c) Use for any future adjustments and/or replacements, products and/or components other than those listed in this document, and in any case provided by the manufacturer.



**The manufacturer cannot be held responsible for any fault caused by reasonably foreseeable misuse AS IN THIS DOCUMENT CITED AND DISPLAYED.**

## 4. Safety Instructions

### 4.1. INDICATIONS OF PRESENT RESIDUAL RISKS

#### RESIDUAL RISKS



**The manufacturer**, in compliance with Directive 2001/95/EC on general product safety, has developed and implemented a product design, manufacture and packaging system to ensure the safety of the product placed on the market, for the protection of consumers/users. In order to implement measures to promote the improvement of the safety and health of the users of the product, the manufacturer shall ensure that residual risks are eliminated or reduced, and where they cannot be eliminated give due notice to the user.

**WHEREAS**, at the design stage, the types of material to be used and the respective mechanical workings necessary to be able to eliminate the dangers of contact cutting or shearing were well identified, for any adjustments to be made, the permanent residual risks are reported below.

#### PRODUCT USE



**The product should be used only for the purpose to which it is expressly intended.**



The installer and maintainer, in addition to being adequately informed and trained and operating with caution and paying attention to the warnings on the product and in this document, **must always employ utmost care during regular use and adhere to the intended mode of use.**



#### RESIDUAL RISK DUE TO THE PRESENCE OF SHARP EDGES



There is a residual risk to the user during installation and subsequent use of the product due to possible accidental contact and impact with sharp edges present in the product, which could not (due to manufacture requirements) be reduced, by the use of fittings / bevels.



## RESIDUAL RISK DUE TO PROCEDURES REQUIRING MANUAL OPERATIONS



Procedures for installation, adjustment, maintenance, and cleaning of the product or its parts, although performed in accordance with the instructions in this handbook, are manual operations that involve residual risk due **primarily to impact, crushing, dragging, scraping, or abrasion.**



These operations require a considerable degree of attention on the part of the operators; the person in charge of the operations must properly inform personnel of these residual risks.



Therefore, both the operator and the maintainer must be properly informed and trained whenever they carry out manual operations, and **in addition to complying with the intended mode of use, they must use hand protection devices.**

## 5. Packaging Composition, Shipping and Commissioning



Only authorized and properly trained personnel with sufficient technical experience **are permitted to handle the product.**



**Personnel handling the product** should be aware that knowledge and application of safety regulations is an integral part of their work. Before handling the product, carry out the following steps:

- > read the technical documentation carefully,
- > know the parts and various devices of the product, their location and function.



**Before beginning the installation phase**, the installer-maintainer must be fully familiar with:



- > the location, function and use of all devices,
- > the location, function and use of all adjustments,
- > the features of the product,
- > this handbook and how to consult it.

**The installer-maintainer must also** have received proper training.

## 5.1. PACKAGING COMPOSITION

### COMPOSITION OF THE PRODUCT WITHIN ITS PACKAGING

The product is supplied by the manufacturer, packed in a rigid material package, lined on the inside with polyurethane foam for the prevention of impacts that could generate scratches, etc.

The product within the above package is presented divided into two sections/components (produced through the use of 3D printer), namely “Gauge Body” and “Supporting Bar.”



## 5.2. STORAGE, SHIPPING AND HANDLING

### STORAGE

In case of storage, the product should be stored in an airy room, protected from dust. Items delivered should be kept packed until final installation.

In case of **long inactivity**, the product should be stored with precautions regarding the place and time of storage:

- 1.Store the product in a closed place;
- 2.Protect the product from impacts and stress;
- 3.Protect the product from humidity and excessive temperature changes (refer to the table below);
- 4.Prevent the product from coming into contact with corrosive substances.
- 5.Check that the packaging has not been damaged and that it is perfectly dry. The product is designed to withstand the temperature, humidity and vibration of shipping and storage.

Room temperature	-25 / +40 °C 0 / +40 °C	-25 / +40 °C 0 / +40 °C Avoid places where sudden changes in temperature can cause condensation or freezing
Storage temperature	-25 / +55 °C 0 / +55 °C	
Relative humidity	100% at the temperature of +25°C Less than 50% at the temperature of +40°C Less than 90% at the temperature of +20°C	
Vibrations	5.9 m/s <sup>2</sup> (0.6G) or higher	
Atmospheric pressure	900 mbar or higher	

Storage temperature is intended as short-term values such as shipping. Condensation or freezing normally occur in places where temperature changes are large. Although the relative humidity in such cases may be within the values given in the table, such places should be avoided.

### TEMPORARY DECOMMISSIONING



Temporary decommissioning of the product involves placing it back into its packaging and storing it according to the requirements of the previous chapter.

### SHIPPING, LIFTING AND HANDLING

#### GENERAL RULES FOR SHIPPING - HANDLING

Handling personnel should check the weight of the product (even in functions of stacking several products in one pallet and/or box) to choose the most appropriate means for lifting/handling.

Take every precaution to exclude any possibility of product damage. **When handling the product and/or load, risks of falling, hitting or tipping the product should be avoided.**

### 5.3. INSTALLATION AND COMMISSIONING

#### INSTALLATION



The commissioning of the 'Adjusting Calipers Mod. RSR01' is allowed and inherent, only following the proper installation of the "Adjustable Stock Mod. FUTUR-K6AM" on the stock of a firearm (rifle).



**Installation of the product should be performed only by competent personnel: INSTALLER-MAINTAINER-COMPETENT PERSON.**

#### Mounting/Installation Procedure:

> Open the package and take out the product stored inside:



> Insertion of the supporting bar fork, inside the gauge body:

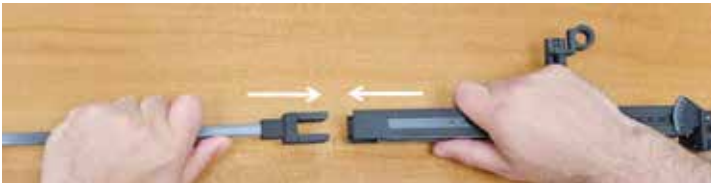



> Visual check of correct hole alignment:

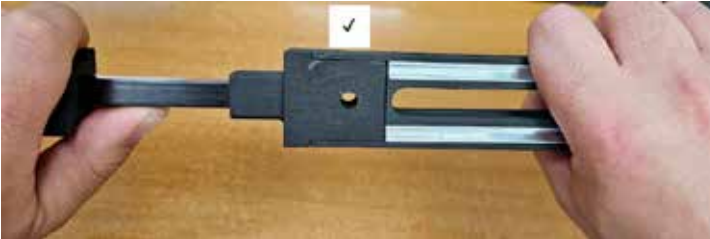

> Insertion of the threaded knob inside the pin, for attaching the supporting bar to the gauge body:

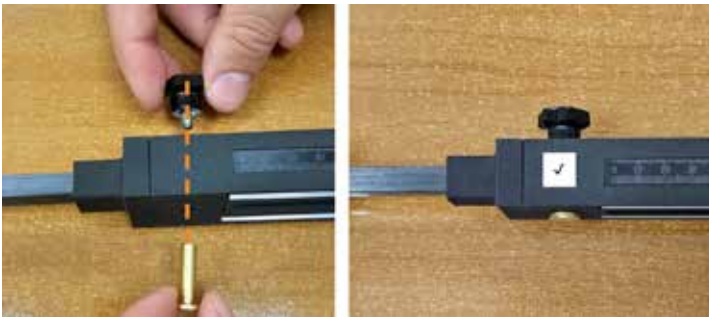

> Correct installation/mounting of the product:



## 6. Product use

### 6.1. INTENDED USE

The product 'Adjusting Calipers Mod. RSR01', is a measuring tool, designed to assist the user in the optimal adjustment of all moving parts such as comb height, pitch, translations and rotations, of the 'Adjustable Stock Mod. FUTUR-K6AM' installed on the stock of a firearm (rifle); in particular, it is possible to perform:

#### PITCH ADJUSTMENT

By positioning the rear transparent panel so that it is parallel to the butt plate armature, the angle of the stock on the line of fire (pitch) can be measured on the lateral fan goniometer.



#### ADJUSTING THE ROTATION AND DEVIATION OF THE BUTT PLATE

By observing the back of the rifle through the transparent panel, as in the figure, both the lateral deviation from the axis of the rib and the angle of **rotation of the two levels of longitudinal symmetry can be detected: that of the rifle and that of the butt plate.**

## ADJUSTING THE HEIGHT OF THE BUTT PLATE AND THE COMB

With the slider moving horizontally and the sensor moving vertically, **the position of the butt plate in relation to the rib** can be measured from the tip (which is the highest point of the comb), to the bottom (which is the lowest point). By moving the slider, in the same way, **the height of the butt plate can be measured**, again referring to the height of the rib. The horizontal graduated scale has the function of referencing the position of the sensor horizontally, when the latter takes the vertical dimensions.



## POSITIONING OF THE CALIPERS ON DIFFERENT SIZED RIBS

The calipers can be used for both 10-mm-wide and 11-mm-wide ribs by simply coupling the bar (which contains the magnetic holders) onto the body in the two possible ways rotated 180°. The magnetic holders, in fact, have tracks 10 and 11 mm wide, respectively.





In its **REGULAR** and reasonably foreseeable USE, the product can only be used:  
As a measuring tool to chart the optimal adjustment settings, in terms of comfort and shooting setting, thus creating the checklist of personal parameters, so as to achieve a perfect feeling with the firearm (rifle), and be used by No. 1 user.

## 6.2. PRECAUTIONS FOR USE

Before positioning the tool on the rib, make sure that the rifle:

1. is unloaded and the tank/loader, if any, is completely emptied of bullets;
2. throughout the adjustment operations, is kept stably fixed on suitable support that prevents it from accidentally moving or falling.



## 7. Maintenance, Lubrication, Cleaning

### 7.1. GENERAL INFORMATION - REQUIREMENTS OF THE MAINTAINER



By '**maintenance**' should be understood not only the periodic check of the regular functioning of the product, but also the analysis and consequent remedy of all those causes that for whatever reason put it out of service.



It is clear, therefore, that maintenance involves a range of mechanical and functional problems of various magnitudes that require the attendant to have a good theoretical-practical knowledge of the product and its use.



In particular, **personnel**, who are entrusted with **maintenance, cleaning, parts replacement and troubleshooting**, should set themselves the following aims:

1. limit the decay of wear parts;
2. minimize accidents;
3. contain accidental fault costs;
4. limit the number and duration of interventions;

**Personnel** in charge of **maintenance, cleaning, parts replacement and troubleshooting** for the achievement of these aims will be bound to comply with certain basic rules, and in particular they must:

1. carry out lubrication schedules on time (if scheduled);
2. cooperate in the definition and management of spare parts, to be obtained exclusively from the product manufacturer.

It is imperative that **maintenance, cleaning, parts replacement, and troubleshooting** activities performed by the user be **entrusted to experienced, competent, and authorized personnel**.

## 7.2. INTERVENTIONS THAT CAN BE PERFORMED BY PRODUCT USERS

### INTERVENTIONS THAT CAN BE PERFORMED BY PRODUCT USERS

The following are all periodic **checks/verifications, adjustment and setting** interventions, and ORDINARY MAINTENANCE interventions that can also be carried out by the **product user**.

FREQUENCY	CHECK	MODES AND FEEDBACK
Before each USE	<ul style="list-style-type: none"> <li>the completeness of the product in its parts</li> </ul>	Before each use, make sure the product is complete with its parts
Before each USE	<ul style="list-style-type: none"> <li>the tightening of all elements</li> </ul>	Before each use, make sure the elements (threaded knob and pin) are properly tightened.
At least on a monthly basis	<ul style="list-style-type: none"> <li>visually for integrity of all threading and movement lanes between parts</li> </ul>	Check and, if necessary, proceed with cleaning in case of poor readability, of the graduated numerical indicators

## 8. Average Lifespan, Demolition and Disposal

### 8.1. AVERAGE LIFESPAN



The average lifespan of the product is estimated by the manufacturer to be 20 years, as long as it is verified according to the maintenance methods, integrity, and depending on the use and measurement cycles performed.



In the event that the decision is made to no longer use the product herein, because it is obsolete and/or irretrievably faulty or worn to the point that it is not cost-effective to repair, it must be **taken out of service by rendering it inoperative and free of potential hazards**.

If the customer does not have adequate personnel or equipment to be able to carry out the demolition procedure under absolutely safe conditions and in such a way as to ensure the safety of the operators, please contact the product manufacturer's technical staff.

## 8.2. DEMOLITION AND DISPOSAL



Before carrying out dismantling, demolition and disposal of the components constituting the product, consult the product manufacturer, who will indicate **how to operate in accordance with the principles of safety and environmental safeguard.**



Dispose of them by working in accordance with current regulations, addressing the appropriate organizations and/or companies specializing in scrapping and/or waste disposal, so that separation between plastic material, metal material and paper material takes place.

The product **can be disposed of without the need to reduce it to minute pieces**; simply disconnect the main elements that compose it and place them in the appropriate waste bins, performing appropriate sorting of the CARBON FIBER / NYLON / ALUMINIUM / PLEXIGLASS elements.

**It is forbidden and also subject to penalties** to abandon the product in the environment.



# **FUTUR-K6AM**

**Produced and distributed by:**

Futurmec S.r.l. - Urbania (PU)

Email: [commerciale@futurmecurbania.com](mailto:commerciale@futurmecurbania.com)

Tel. +39 0722 312966 [www.futur-k.com](http://www.futur-k.com)

 MADE IN ITALY 



Check out the new  
**Tutorial** section

